

PLAN VIEW
HORIZONTAL SCALE: 1 : 250

RECEIVED AND PROCESSED
BY LAND DEVELOPMENT
INITIALS. *[Signature]*
JUL 13 2017

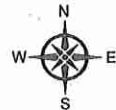

NOTES:

600	INSTALL 864F FDH ON CONCRETE PAD WITH 2x BOLLARDS. SEE DETAIL 'C' SHEET 600
601	STUB 2-100mm DUCTS 0.6m ABOVE FINISHED GRADE
602	INSTALL (2) 100mm DBII PVC CONDUIT L= 5.0 m. SEE DETAIL 'B' SHEET 600
603	CORE FOR 2-100mm CONDUIT IN TELUS MH-288 SEE DETAIL 'W' SHEET 600

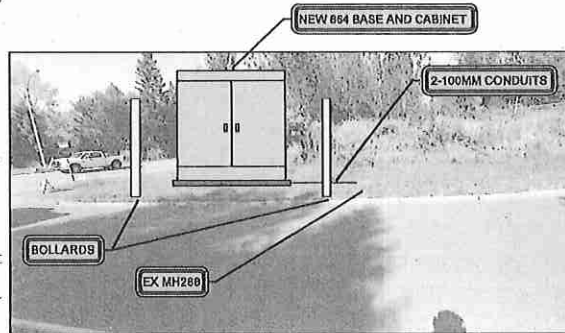

JINKERSON RD & TESKEY WAY
FDH - SITE PLAN
N.T.S.

CAUTION.
GAS FACILITIES IN AREA
LOCATE AND EXPOSE
PRIOR TO COMMENCING WORK

METHOD OF PLACEMENT
VIA OPEN TRENCH UNLESS
OTHERWISE NOTED

ALL MEASUREMENTS ARE IN
METERS UNLESS NOTED

Sheet Title:
Design

Function:
Make ready

Task:
FDH Placement

Rev Map:

BC ONE CALL
CALL BEFORE YOU DIG
1-800-485-5050
OR BY CALLING 811
UNDEGROUND AREA 877-6000
CALL AT LEAST 48 HRS BEFORE DIG
EXCEPT FOR EMERGENCY

Client:
TELUS

Prepared By:
FAFL
SUITE 200 - 7485 130 ST
Surrey BC V3W 1H8

Rev	Date	Notes	QC
-	-	-	-
-	-	-	-
-	-	-	-
-	-	-	-
-	-	-	-

INR: May 20 2017

DRAWN BY: TARANA AHAMMED
DESIGNED BY: KADTEC SYSTEMS

Proprietary Information
Not for disclosure except under written agreement

Scale = 1:250
0 2.5 5.0 7.5 10.0

Project:
Falcon 2017
SRDS 3033B - 2629284
Sardis, BC

File Name:
(DWG) SRDS 3033B - 2629284FDH

COID	Route
SRDS	3033B
Network Number	Sheet Number
2629284	600

Date: July 12, 2017 Author: Kat McCawley 604-444-3732 ext 247 Project: SRDS 3033B- 2629284 FDH
Universal Flagging: 170-8061 Lougheed Hwy. Burnaby, BC V5A 1W9 Office: 604-444-3732 Dwg: 001

Comments:

TELUS
Kelly Buchanan: 250-485-7330

City of Chilliwack
Job location: Jinkerson rd and Teskey Way
Closure description: SLAT on Jinkerson Rd
Tentative date and hours: July 31 - September 15, 2017
Job description: Civil Construction - New Conduit and pad construction for Fibre Distribution Hub Cabinet

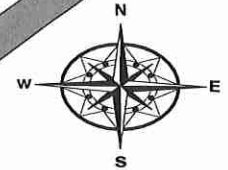

Advanced Warning Sign distances may be shortened due to Urban block length

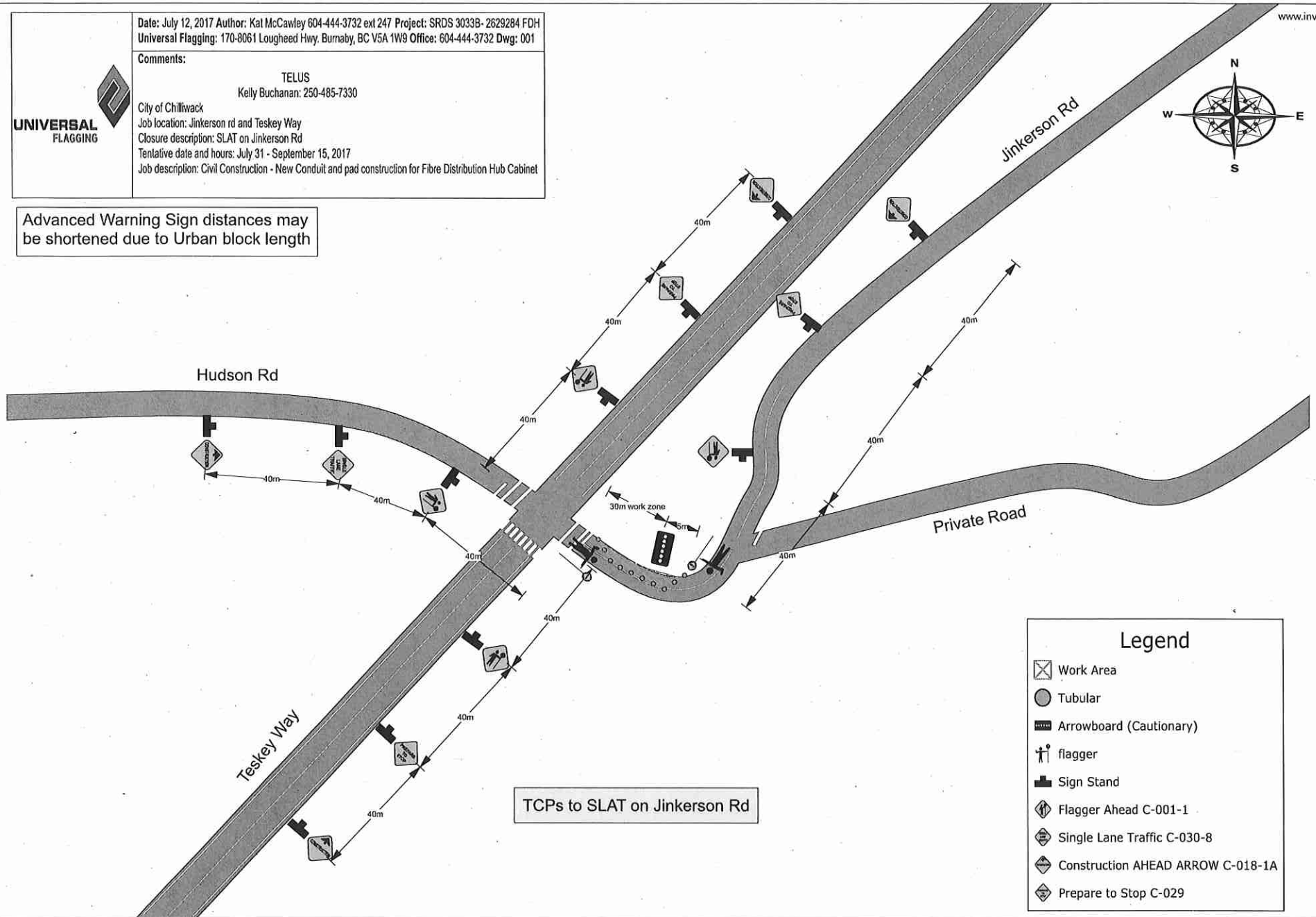

TCPs to SLAT on Jinkerson Rd

Legend

- Work Area
- Tubular
- Arrowboard (Cautionary)
- flagger
- Sign Stand
- Flagger Ahead C-001-1
- Single Lane Traffic C-030-8
- Construction AHEAD ARROW C-018-1A
- Prepare to Stop C-029